



PRODUCT CATALOGUE

ATLAS RUBBERS & ENGINEERS

Registered Office & Works:



Talepukur Dhar, Makardah, Howrah Amta Road, Howrah - 711409, West Bengal, India



atlasrubberkol@gmail.com



+91 - 99035 02104
+91 - 97485 43573

www.atlasrubbers.com
GSTN: 19ABOFA8290R1ZA
UDYAM-WB-08-0006480

OUR WORKS

For thousands like us, the rubber tree is a tree of life, serving as a crucial source of income for earning a living and raising families.

“ We really owe a great deal to the rubber tree ”



From the HO's Desk



Dear Customer,

It gives me immense pleasure while addressing you through this small familiarizing letter you with activities, which we carry out at **“Atlas Rubber & Engineers”**, Howrah. Every thing started about **32 years** ago at **National Rubber Industries, Howrah**. We started with manufacture of small parts such as bush & Diaphragms & now we manufacture **sophisticated Industrial Rubber parts as per various drawings, standards & specifications, Conveyor Belts as Per IS Specifications, calendared Rubber Sheets & extruded products** for the industry & hence catering the needs of Industries in almost all the segments & sectors.

This gives us a satisfaction, which is momentary, & again it becomes a challenge to scale new heights in quality & marketing.

Production & Diversification Here I utilize this opportunity to promise that Atlas will continue its philosophy of sustained growth with quality at economy.

This has been possible with active participation of our management, staff & workers, every one has contributed in their own manner & ultimately it is the teamwork that has won.

Here we also utilize the opportunity and thank our most revered customers' because without their unwavering, staunch support & encouragement we could not have reached where we are today. We at **“ATLAS”** believe in providing a product, which is the best in quality & competitively priced.

With a vision to receive your valuable enquiry & long way to go together.

Rajat Jain



OUR PRODUCT RANGE

- Rubber Lagging, Vessel Lagging, Pulley Lagging, Ceramic Lagging
- Rubber Sheet, Neoprene Rubber Sheet, Nitrile Rubber Sheet as per IS Specification
- Neoprene Rubber Diaphragm for Glass Lined, Rubber Line Diaphragm Valves of all sizes.
- Viton Rubber, Silicon Rubber, Butyl Rubber, Neoprene Rubber, Nitrile Rubber 'O' Ring, Oil seals, 'V' Type Seal, 'X' Type Seal as per your specification and drawing.
- Rubber Strips, Rubber Skirt Board Strips, Rubber Scraper, Rubber Idler Ring, Rubber Pulley, Rubber Liners as per your specification.
- Rubber Spouts, Rubber Stencil Sheet for Branding, Rubber Numbers, Rubber Buffers for Wagon Tippler, Rubber Springs.
- Neoprene Rubber Bucket, Ring, Bellow for compressor, Expansion joint as per specification.
- Rubber Wheels for Trolley, Rubber Tyre for Tyre wheel Coupling, Coupling Pads, Coupling Diaphragms, Rubber Bushes for Coupling, Conical Rubber Ring. Washers, Brass Lined Rubber Bushes.
- Rubber Channel, Rubber Packing Strips, Rubber Bokrup Strips, Rubber Cord, Rubber Packing Ring, Rubber Bush for Doors.
- Rubber Wiper Seal, Rubber Gland Packing, Neoprene Rubber Gland Packing set.
- Rubber Ring for Pan, Vulcanizer, Crystal Discharge Valve, Rubber Ring for Man-Hole, Rubber Buffers for Centrifugal pump.
- UHMW PE Liners, Sheets, Ceramic Liners for Chute.
- Rubber Electrical Mat as per IS-15652 : 2006.
- All type of Rubber Parts as per your Drawing & Specification.
- Specialist in Viton Rubber, Silicon Rubber and Butyl Rubber Parts

"Coming together is a beginning, Keeping together is progress and Working together is success"

Introduction to PULLEY LAGGING



Why Pulley Lagging?

- Prevents slippage-reduces pulley wear
- Prevents material build up on pulley
- Reduces chances of mistracking
- Reduces damage to the conveyor belt
- Allows for easy drainage of water and slurry

RANGE OF PULLEY LAGGING

Our range of pulley lagging spans from a lighter weight resistant finish to a robust, heavy duty finish and is available where protection against abrasion, chemicals, heat and noise are required. We can also prepare the external surface treatments and provide painting.

ATLAS RUBBERS offer both plain and patterned pulley lagging with specially developed rubber materials and their plain and patterned surfaces have proved to be very effective in water shedding, preventing material build up and controlling belt slippage.

All lagging products can be provided with a bonding layer for easy installation with cold glues.

Advantages of Bonding Layer:

Stronger bonding | Reduced down time

Pulley Lagging Selection Chart				
Criteria	Plain Sheet Lagging	Diamond Sheet Lagging	Rubber Strip Lagging	Ceramic Strip Lagging
Dry Performance	Very Good	Excellent	Excellent	Excellent
Wet Performance	Average	Very Good	Very Good	Excellent
Wear Life	Very Good	Very Good	Very Good	Excellent
Ease of Installation	Good	Good	Excellent	Excellent
Fire Resistance	Yes	Yes	Yes	Yes
Drainage Grooves	No	Yes	Yes	Yes



PLAIN RUBBER & DIAMOND SHEET FOR PULLEY LAGGING

ATLAS offers a comprehensive range of Plain & Patterned Sheet Pulley Laggings to suit every conceivable conveyor installation. These are produced in different thicknesses, rubber qualities and patterns to ensure selection of the most appropriate type, to suit all application requirements.

The Sheet Pulley Laggings comes with CN Bonding Layers for better adhesion levels as also with buffed surface. The profiled patterns on the top surface, in diamond embossing improve belt grip and tracking on conveyors, while reducing belt wear. The Sheet Pulley Lagging is available in various grades of rubber, including FRAS and HRAS.



Range of Rubber Compounds for Lagging

S. No.	Properties	Units	Compound Code			
			AR-6070S	AR-6070M	AR-7075S	AR-7075M
1	Tensile Strength	Mpa	20.5 Min.	16.0 Min.	18.0 Min.	15.0 Min.
2	Elongation at Break	%	450 Min.	400 Min.	450 Min.	400 Min.
3	Shore Hardness	°A	60 ± 5	60 ± 5	65 ± 5	65 ± 5
4	Density	g/cm ³	1.10 ± 0.03	1.13 ± 0.03	1.20 ± 0.03	1.15 ± 0.03
5	Abrasion Loss	mm ³	90 Max.	140 Max.	150 Max.	200 Max.

Profile Dimensions & Range:

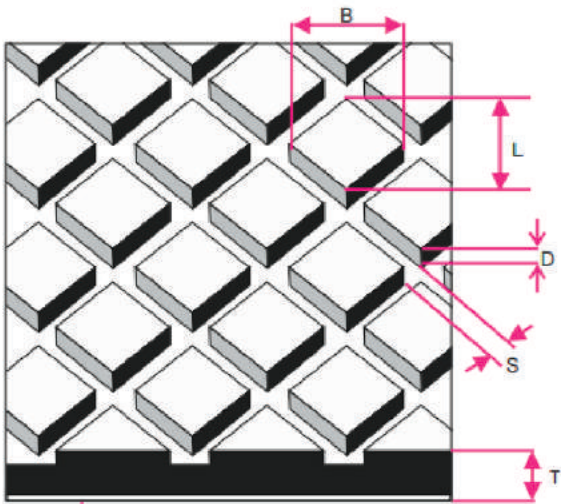

Benefits:

- Easy to fit
- Minimizes wastage
- Outstanding wear and abrasion resistance
- Reduced adhesive use
- Reduced labor
- Reduced down time

Profile Diagonal	B
Profile Diagonal	L
Gap Between the Profile	S
Depth of Profile	D
Minimum Thickness	T

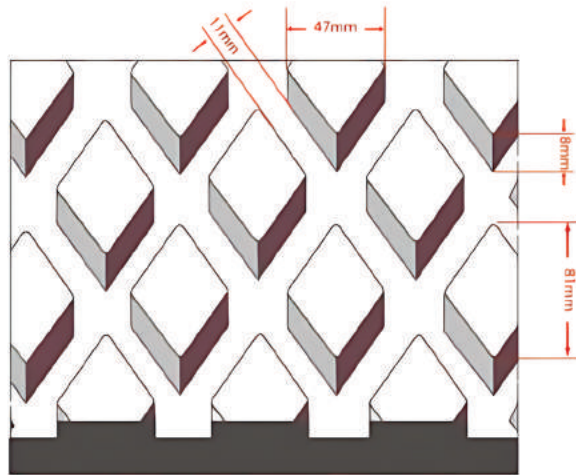

LARGE DIAMOND DESIGN
(With 12,15, 20mm Thickness)

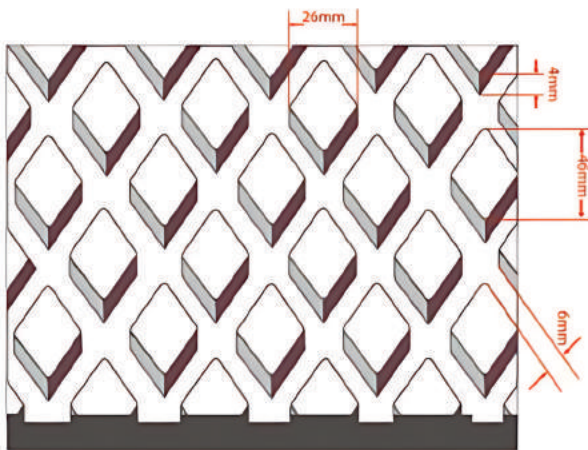

MEDIUM DIAMOND DESIGN
(With 10, 12, 15mm Thickness)

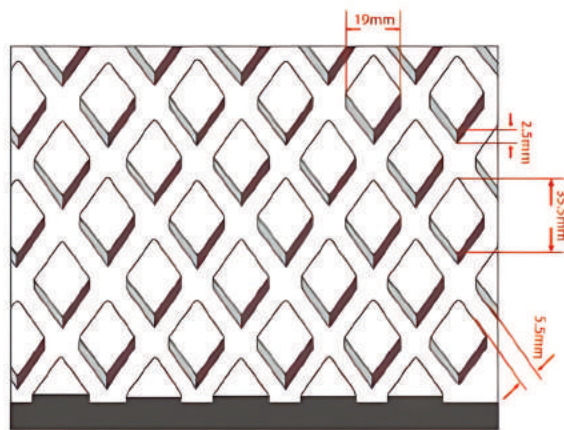

MINI DIAMOND DESIGN
(With 6.6mm Thickness)

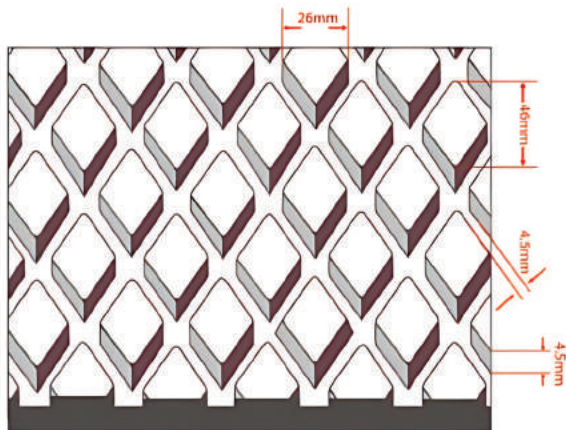

MEDIUM DIAMOND DESIGN
(500mm x 500mm, With 20mm Thickness)

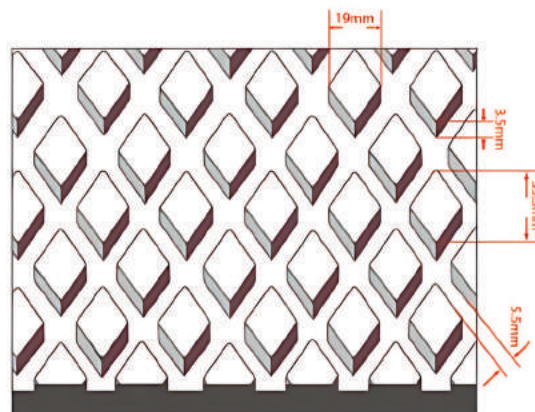

MINI DIAMOND DESIGN
(With 8, 10, 12, 15mm Thickness)



CERAMIC SHEET FOR PULLEY LAGGING

ATLAS Ceramic Pulley Lagging provides the best grip for your drive pulley. The ceramic inserts in the lagging surface provide both high friction and high wear resistance-providing the best protection for your pulley and belt in the most demanding conditions.

The Sheet Pulley Laggings comes with CN Bonding Layers for better adhesion levels as also with buffed surface. The Sheet Pulley Lagging is available in various grades of rubber, including FRAS and HRAS.

BENEFITS	FEATURES
Improved traction as dimples grip belt	92% Aluminium Oxide tile material
Improved belt tracking due to positive grip	Low Sulphur Rubber Compound
Reduced belt tension required due to increased co-efficient of friction	Ceramic Tiles fully encapsulated and chemically bonded to rubber on 5 sides
Outstanding Adhesion: <ul style="list-style-type: none"> • Rubber to Ceramic • Rubber to Metal • Rubber to Rubber 	Supplied in wide strip forms with bonding layer and buffed back surfaces
Tiles more resistant to cracking or "pull out"	Rubber Compound blended with CN polymers for better parameters.
Suitable for use in underground mines	Special Rubber compound to meet FRAS and MSHA requirements
One product suits all pulley face widths	Ensures high bonding strength to the pulley surface between rubber and metal
For customers who prefer a rubber edged pulley lagging	Can be supplied as individual strips with rubber section at each end of Ceramic section

Comparison Chart for Co-Efficient of Friction

Condition	Steel	Rubber Lagging	Ceramic Lagging
Dry	0.32 to 0.40	0.42 to 0.50	0.75 to 0.84



VIEW 'X'

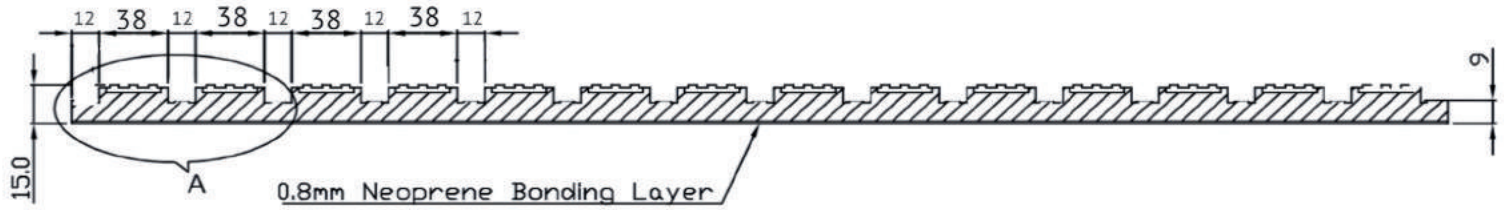
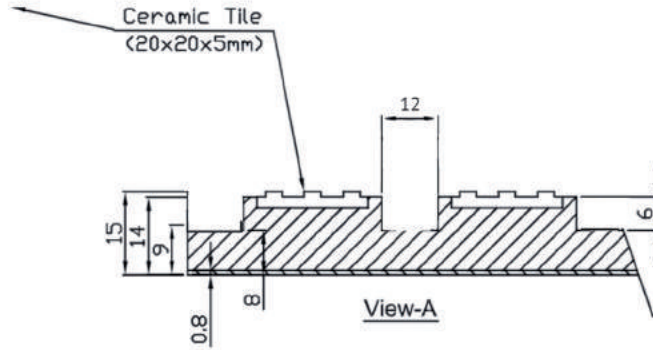
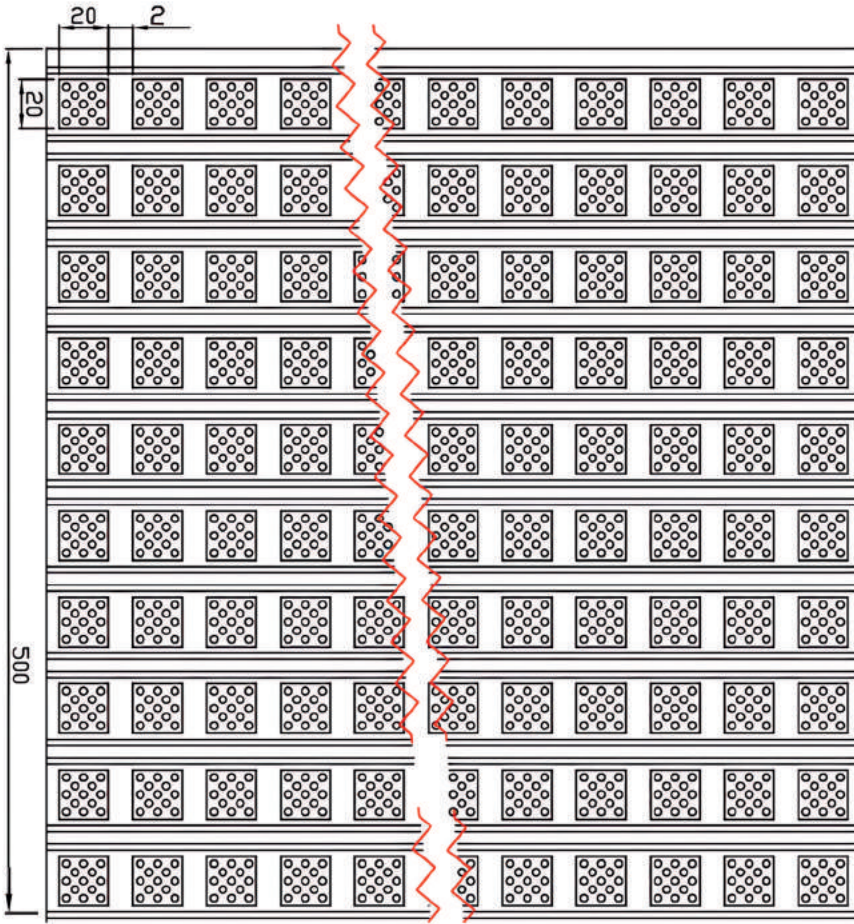

Ceramic Tile Specifications

Aluminium Oxide (min) Al ₂ O ₃	92.30%
Density (gm/cc)	3.65 +/- 0.05
Hardness (HV5)	1150 - 1200
Width	19.60 - 20.40
Thickness	4.80 - 5.20
Colour	White
Water Absorption	0%

Test Specification

Slurry Erosion Test	0.0017 grams
Rubber Wheel Abrasion	0.0166 grams

Base Rubber Specification

Compound Code	AR-6070 SR
Polymer	SBR
Specific Gravity	1.15 +/- 0.03
Shore Hardness °A	60 +/- 5
Elongation at break % Min.	450%
Tensile Strength	18.0 MPa
Abrasion Loss	120 mm ³



Wear Resistant



Fire Resistant

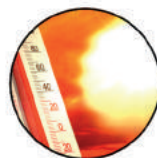

Heat Resistant



Oil Resistant

Why Skirt Sealing System?

Skirt Sealing Systems are used to cover the opening between the Chute and the Belt to restrict spillage.

WHERE IS IT USED?

Skirt Sealing Systems are used to cover the opening between the Chute and the Belt to restrict spillage. ATLAS offers a technically superior, better designed, skirt sealing system to meet stringent operational requirement.

ATLAS RUBBERS offer a technically superior, better designed, skirt sealing system to meet stringent operational requirement. The Skirt Sealing System comes with Skirt Rubber Block, Clamping Plate and Back Plate.

Types of Skirt Sealing System:

1. TWIN LIP SKIRT SEALING SYSTEM
2. SINGLE LIP SKIRT SEALING SYSTEM

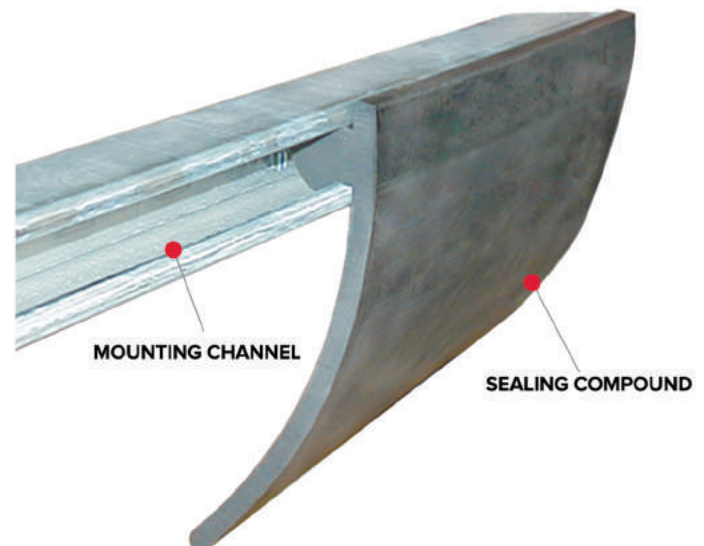

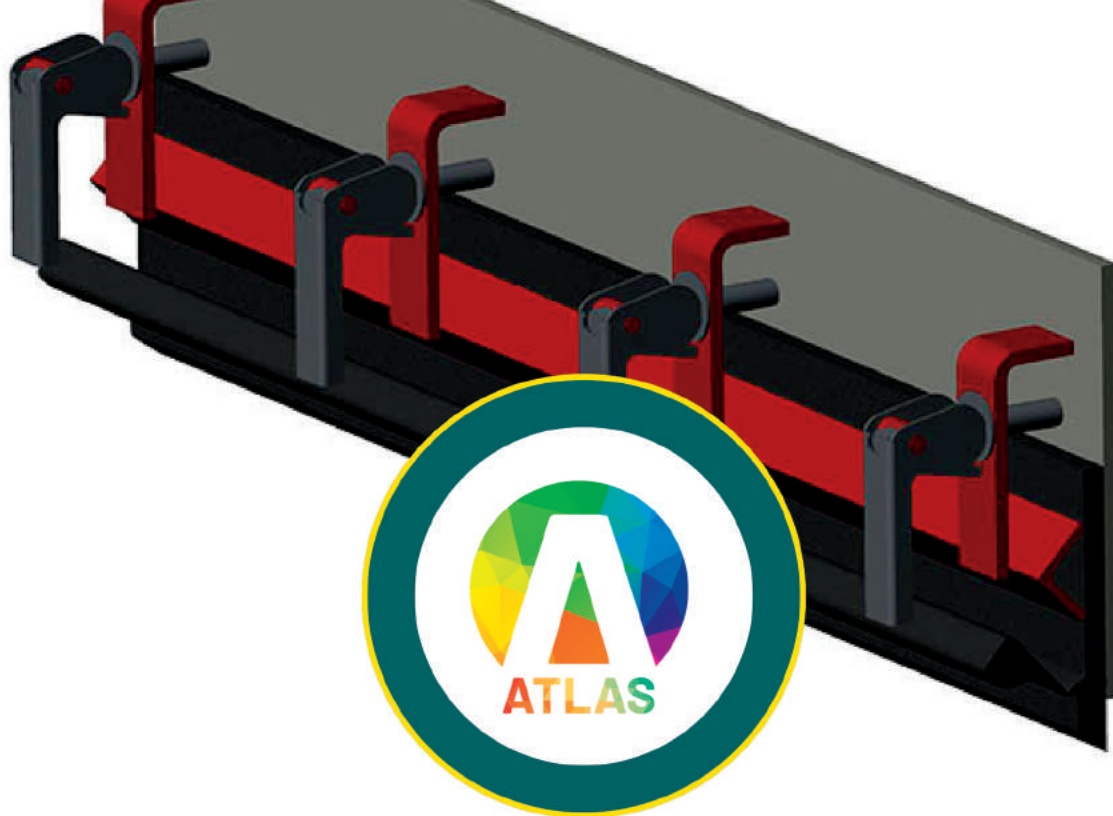

TWIN LIP SKIRT RUBBER SEALING SYSTEM

TWIN LIP SKIRT RUBBER SEALING SYSTEM is a continuous rubber skirt with multiple lip sealing design. The rubber skirt is affixed to the skirt plate by means of a metal clamp which makes it very easy to install and maintain. It prevents spillage without frequent maintenance compared to traditional design. It operates even on belts with very less free edge. Special rubber formulation offers excellent wear and abrasion properties.

ATLAS offers a complete package including design, supply, consultancy, technical support, service back-up and maintenance to assure that our clients will obtain the best benefits at the lowest cost for any trouble shooting and improvement needed in the plant.



Free Edge Requirement

Troughing Angle	Free Edge In (mm)		
	Light Duty	Standard Duty	Heavy Duty
0°	-	3 (80)	3.75 (95)
20°	2.5 (65)	4 (100)	4.75 (120)
35°	3.5 (90)	4.25 (110)	5.25 (130)
45°	3.75 (95)	4.5 (115)	5.5 (135)

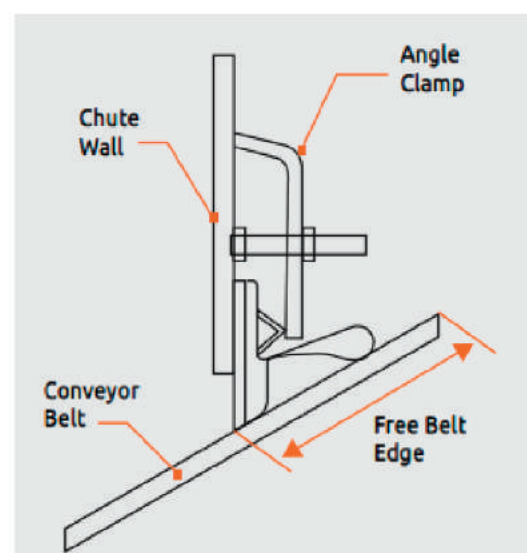

Features

- Excellent for dust containment.
- Works on belts even with free edges as less as 50 mm.
- Offers a dual sealing system in a one piece construction which offers ease of installation.
- Superior Rubber Compound offers excellent wear resistance and very low-abrasion.
- Can be installed on flat belts and 20°, 35° and 45° Troughing angle.
- Light Duty, Standard Duty and Heavy Duty designs available.



Specifications

Duty Type	Dim A In (mm)	Dim B In (mm)	Dim C In (mm)	Dim D In (mm)	Rubber Hardness(Shore A)	
					Grade N	Grade H
Light Duty	4.5 (114)	1/2 (13)	1/2 (13)	2/3 (16)	60 +/-5°	70 +/-5°
Standard Duty	6.5 (165)	1/2 (13)	3/4 (20)	1 (25)	60 +/-5°	70 +/-5°
Heavy Duty	6 (150)	2/3 (16)	1.25 (32)	1 (25)	60 +/-5°	70 +/-5°

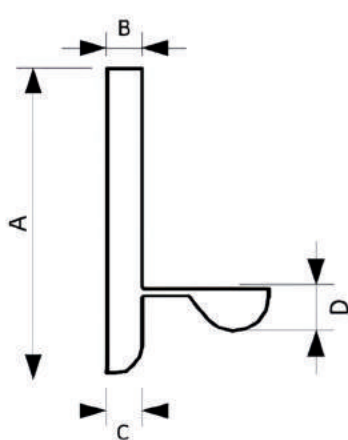

TWIN LIP - LD

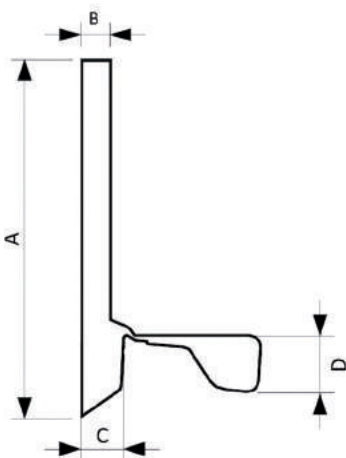

TWIN LIP - SD

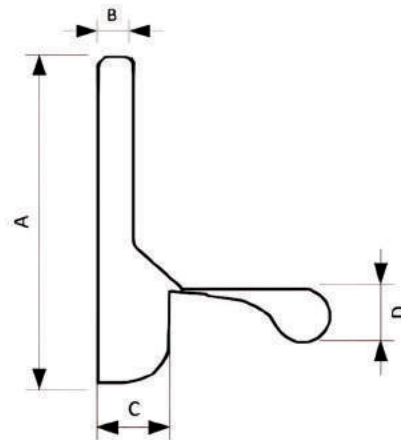

TWIN LIP - HD

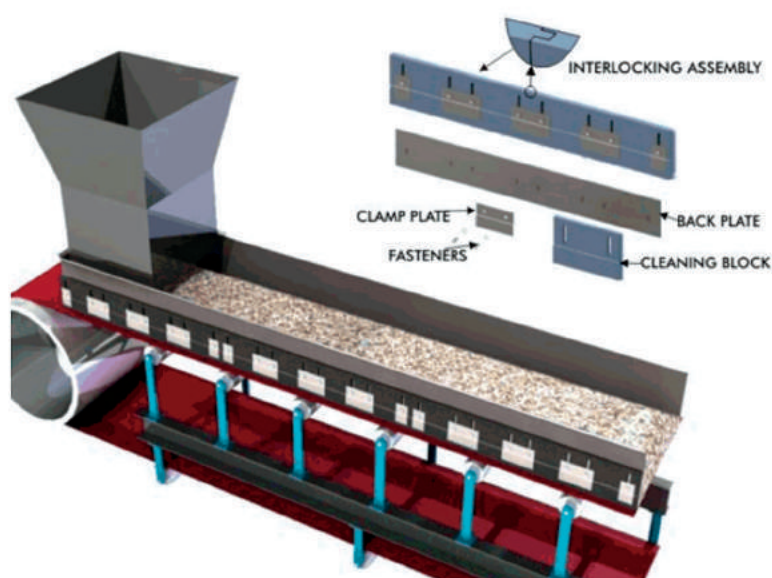



SINGLE LIP SKIRT RUBBER SEALING SYSTEM

ATLAS RUBBERS Single Lip Skirt Sealing System is designed with modular arrangement which contains flat rectangular spillage control blocks that can be installed according to the contour of the belt over the flat backing plate by means of serrated clamps and screw fastening system.

Each block can be moved up and down over the backing plate by loosening the bolts. When the material falls on the belt, it remains agitated and needs to be guided up to a certain distance till it gets stabilized. In general, every chute is attached with skirt board to stop the material from spilling out. The conventional skirt sealing system, made up of long rubber strip leads to gap in the sag portion (between two rollers) of the conveyor. This gap will be effectively sealed with ATLAS's Single Lip Skirt Sealing System which ensures efficient spillage control.

SINGLE LIP SKIRT BLOCKS

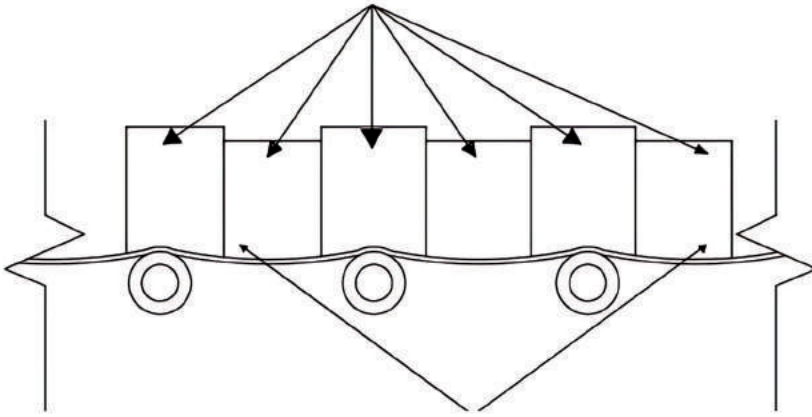

Sources of Spillage Sealed off Effectively

Block Characteristics

1. **Hardness :-** The blocks have a hardness of 60(+/-5) Shore A
2. **Temperature :-**
 - NT Type:** Suitable upto 70°C
 - SHT Type:** Suitable upto 180°C
 - FRAS Type:** (Flame Retardant & Anti-Static) Suitable upto 120°C - 150°C

Variants of Single Lip Skirt Sealing System

Variant	Location	Application	Dimensions (mm)			
			Block Dimensions (W x H x T)	Wear Length of the Block	Standard Module Length	Backing Plate Thickness
AR-SSS-5060	SIDE	LIGHT DUTY	150 x 200 x 25 / 32	65	1050	3 / 5
		MEDIUM / HEAVY DUTY	150 x 200 x 25 / 32	65	1050	3 / 5
AR-SSS-5060	SIDE	LIGHT / HEAVY DUTY	150 x 300 x 32	65	1500	3
AR-SSS-5060	SIDE	MEDIUM DUTY	210 x 210 x 20 / 25	65	1000	3 / 5
		HEAVY / EXTRA HEAVY DUTY	210 x 210 x 20 / 25	65	1000	3 / 5

Fitment of Single Lip Skirt Sealing System

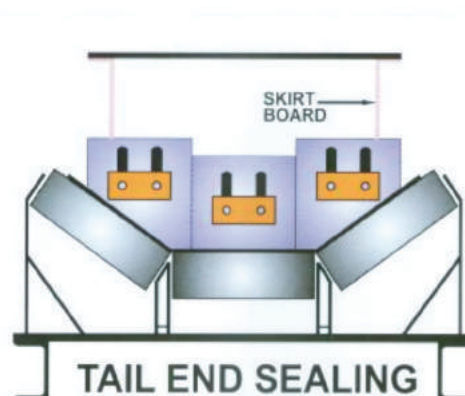
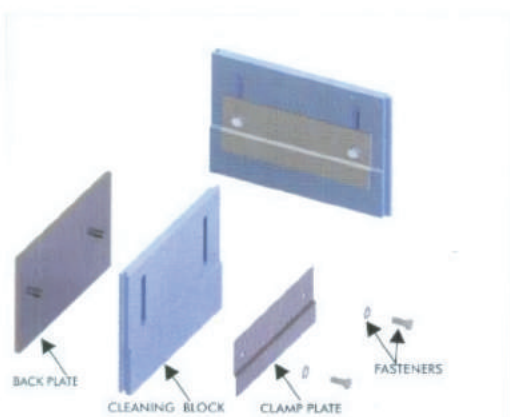



RUBBER LINERS

ATLAS's Rubber Liners are best suited for direct, heavy impact and wear locations of lumpy materials. After long & extensive study of wear components coupled with field experience, Atlas has developed Rubber Liner as a better substitute than the conventional metallic liner.

Applications:

- Bins
- Chutes
- Feeder
- Launder
- Wagon Tippler Hopper
- Wagon Tippler Pad
- Dock Fender
- Truck / Dumper Box
- Track Hopper

Factors considered for optimum design:

- Angle of Impact
- Material
- Material Size
- Bulk Density
- Capacity
- Height of fall



Types of Rubber Liners



1. PLAIN LINER WITH OR WITHOUT HOLES
2. METAL OR STEEL BACKING LINER
3. SERRATED LINER WITH SPECIAL PROFILE FINISH



PLAIN RUBBER LINER

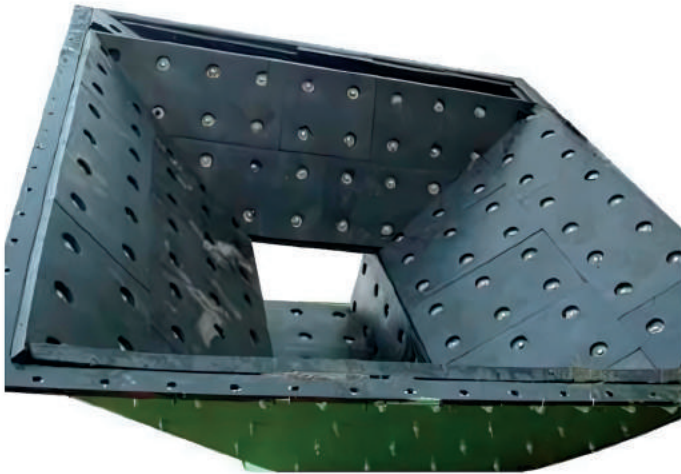

METAL BACKING LINER



SERRATED LINER



Salient Features & Advantages

- High Wear & Abrasion Resistant
- Resilient - reduces noise pollution
- Long Life
- Easy to install and replace
- Special Grades, Thickness & Sizes Available
- Avoids consequential damages



CERAMIC LINERS

Ceramic Wear Liners from ATLAS RUBBERS have proven to be highly effective and long lasting in the mining industry. These liners caters for critical applications where there is a combination of impact, abrasion and flow problem.

Wear Resistant Applications:

- Bins
- Chutes
- Feeders
- Silos
- Wagon Tippler Hopper
- Track Hopper

Advantages:

- Excellent Wear & Abrasion Resistant
- Impact Resistant
- Easy Installation
- Corrosion Resistant
- Long life resulting in reduced downtime
- Good Flowability



Composite Ceramic Liners



Plain Ceramic Liners have a distinct advantage of having excellent abrasion resistance & wear properties. However, it is very brittle and is not suited for direct impact applications especially of heavy lumpy materials.

ATLAS have therefore developed a combination of Ceramic Liners with Polymer, Polyurethane (PU) and Rubber.

- Polymer Based Ceramic Liners: Improved Flowability with high life
- Polyurethane Based Ceramic Liners: For high wear applications
- Rubber Based Ceramic Liners: For good impact applications

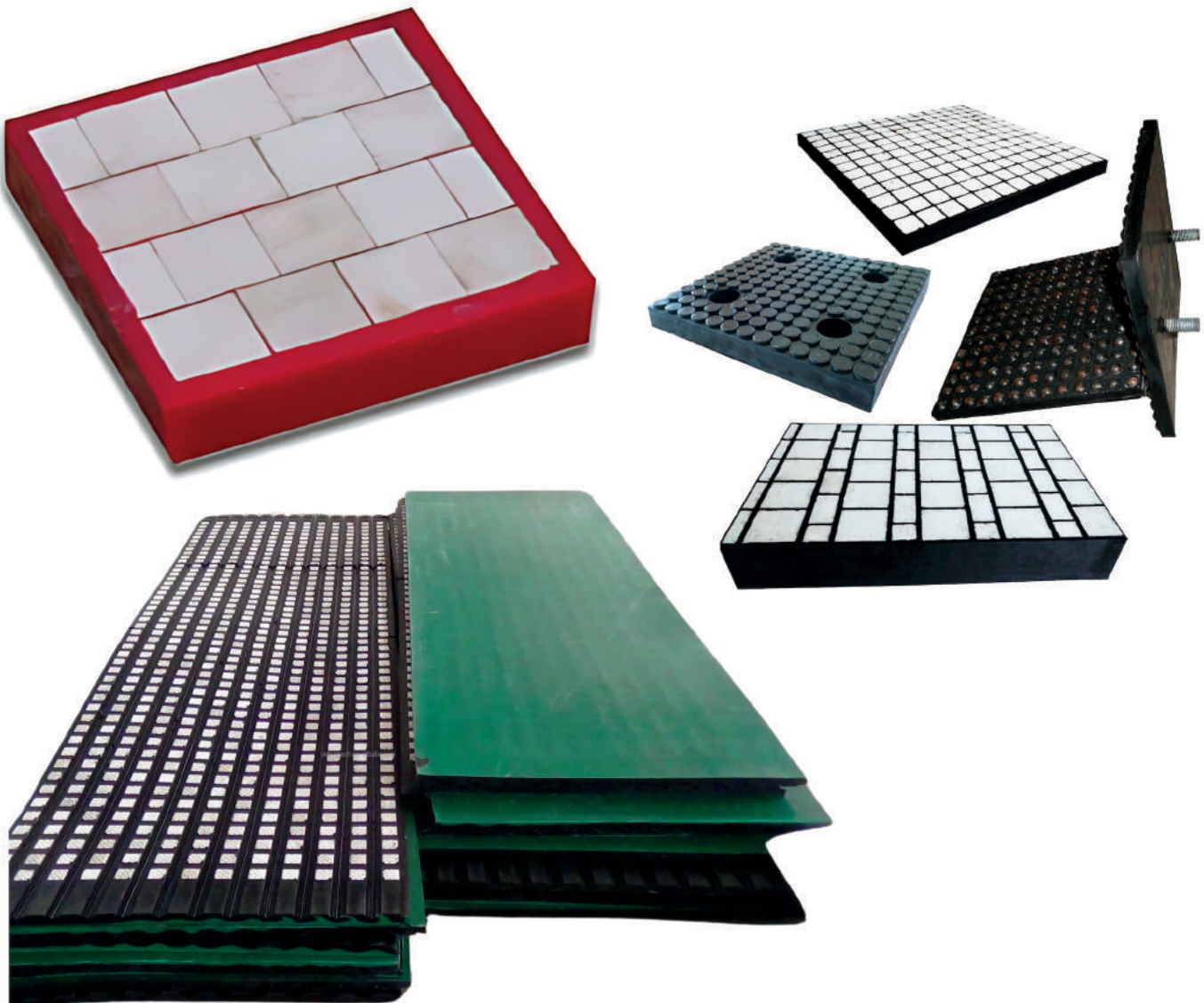



POLYMER LINERS

ATLAS Polymer Liners are manufactured out of various grades of Ultra High Molecular Weight Polyethylene (UHMWPE) that guarantee free flow of bulk material where stainless steel and other lining materials might not have worked.

Polymer liners have very low co-efficient of friction and wax like smooth surface resulting in uninterrupted flow of material, eliminating arching, bridging, rat holing, funneling, jamming and choking problems. Due to high abrasion resistance, the life of bunker or hopper increases considerably resulting in reduced downtime and maintenance costs.

Applications

1. Bunkers
2. Bins
3. Chutes
4. Silos
5. Nodulizing & Mixing Drum
6. Spiral
7. Track Hopper
8. Wagon Tippler Hopper

Materials Handled by Liners

- Bauxite
- Coal
- Coke
- Chemicals
- Copper
- Clay
- Fertilizers
- Gypsum
- Iron Ore
- Limestone
- Laterite
- Lignite
- Sand
- Zinc

Advantages of Polymer Liners

- Free flow
- Increased life of main equipment
- No equipment damage
- Fit and forget system
- Higher capacities of Hoppers for identical head rooms
- No increase in the dead weight because of low density

Salient Features

- Low co-efficient of friction
- Wear and Abrasion Resistant
- Light Weight hence easy to handle, install & fabricate
- Non-Stick Paraffin like surface
- Zero Moisture Absorption
- Very good chemical resistance
- Easy to replace
- Special Grades, Thickness & Sizes Available

Installation

- For MS Surfaces:
 1. Mechanical Fasteners
 2. Weld Washer System
- For RCC Surfaces:
 1. Anchor Shell Fasteners are recommended

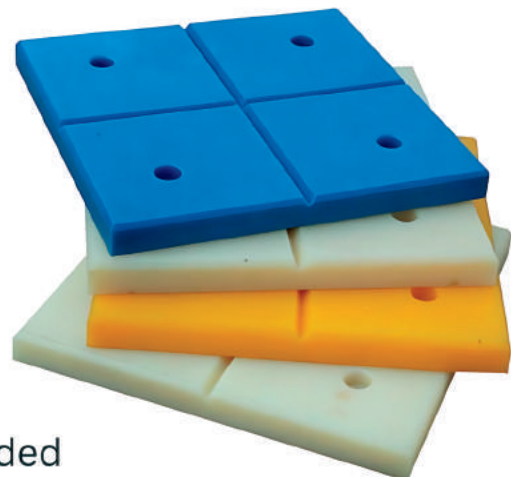



UHMWPE PRODUCTS

UHMWPE (Ultra High Molecular Weight Polyethylene) Products stand out for its very low density, very good sliding properties and at the same time has high toughness.

Because of the toughness, extremely low coefficient of friction and inherent lubricity, UHMWPE is ideal for applications where high levels of friction are likely to arise.

The long term service temperature for UHMWPE ranges between -250°C and approximately $+80^{\circ}\text{C}$

Most widely used UHMWPE Products are:

- UHMWPE Rods
- UHMWPE Sheets

Specifications for UHMWPE Rods

Attributes	Dimensions (mm)		
Diameter (mm)	10-50	50-100	100-200
Length (mm)	Upto 1200	Upto 1200	Upto 1200

Specifications for UHMWPE Sheets

Attributes	Dimensions (mm)		
Width (mm)	1000	1200	1500
Length (mm)	Upto 2400	Upto 2400	Upto 2400
Thickness (mm)	8 - 50	8 - 50	8 - 50

AREAS OF APPLICATION



Food Processing Industries



Conveyor Systems



Paper Industry



Pumping & Valve Parts



Slide Profiles



Mechanical Engineering

CHARACTERISTICS OF UHMWPE

1. Low Density
2. Low coefficient of friction
3. High abrasion & wear resistance
4. Very low water absorption
5. High Toughness
6. High elongation at break
7. High impact strength

UHMWPE PROFILES

UHMWPE profiles are widely used for various industrial applications owing to its tensile strength and good resistance to corrosive media.

These offered products are having excellent density and molecular weight.

It can be manufactured in various customized options in order to meet the various needs of the clients.



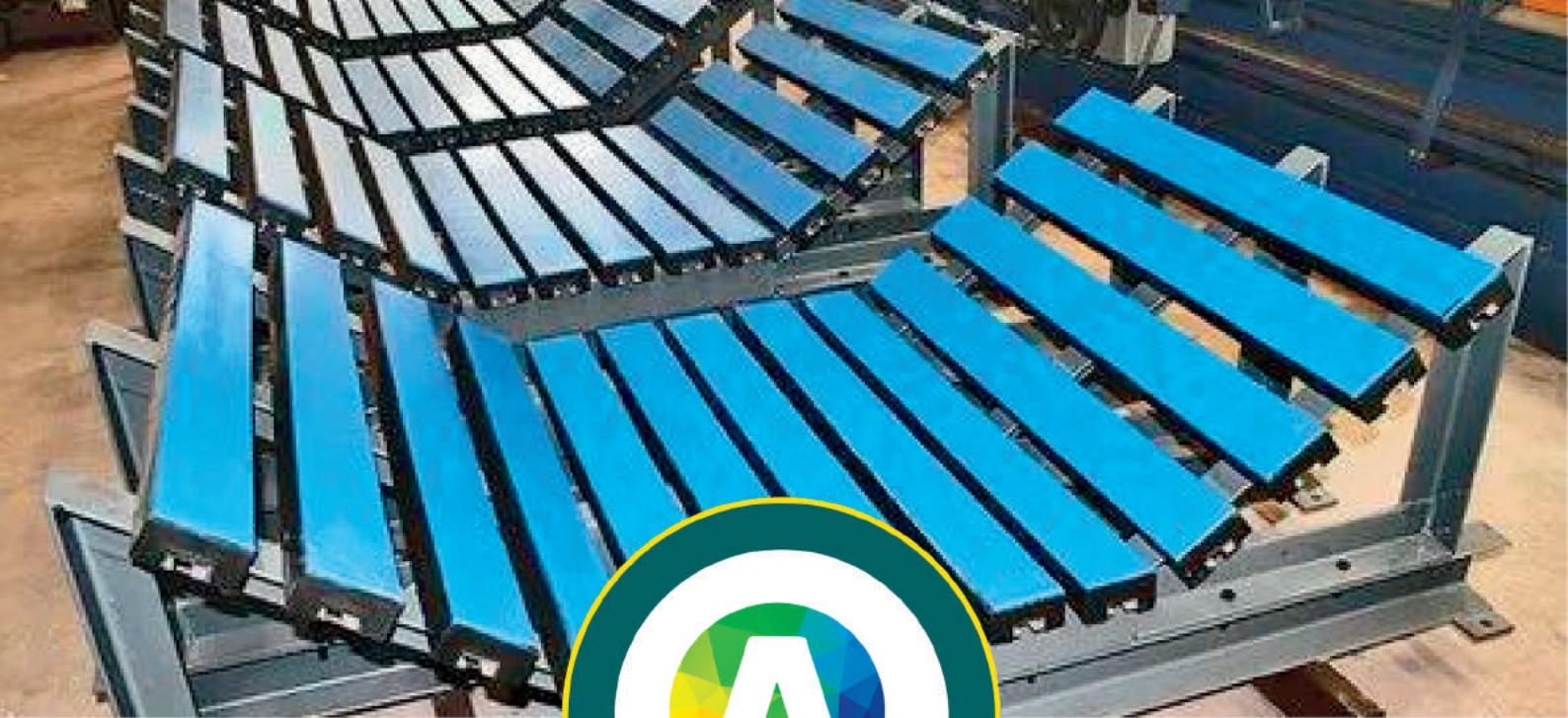

IMPACT PADS

The ATLAS RUBBERS Impact Pad is a fusion of three different layers. The top layer is made of UHMWPE - for smooth gliding of the conveyor belt. The middle layer is of rubber, which is used to cushion the impact load while the lower layer is for fastening impact pads on to the support frame, which is usually made of aluminum. The elasticity of rubber is fully utilized in this product.

The low friction feature of UHMWPE always ensures smooth conveyor movement with minimal wear of belt bottom cover. Atlas's manufacturing facility employs this fusion bonding technique to produce the Impact Pad which has no possibility of separation. Pads may be constructed based on the selection of clamping arrangements.

Product Range of Impact Pad			
Attributes	Dimensions (mm)		
Width	100	100	100
Height (mm)	55 / 75	55 / 75 / 80	55 / 75
Max Length (mm)	1300	1600	1250
Construction Type	H	T	P

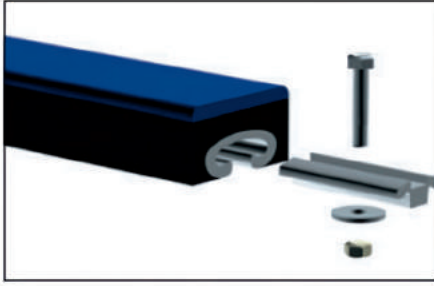

Construction Type H

TYPE 'H'

This is a pad with 'H' type reinforcement and clamping of this pad is done with 'H' type aluminium clamps, hexagonal headed bolts, nylock nuts & washers.

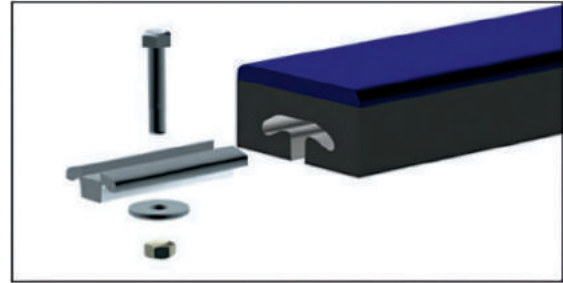

Construction Type P

TYPE 'P'

The 'P' type pads do not contain any reinforcement & is clamped with 'P' type aluminium clamps, hexagonal headed bolts, nylock nuts & washers.

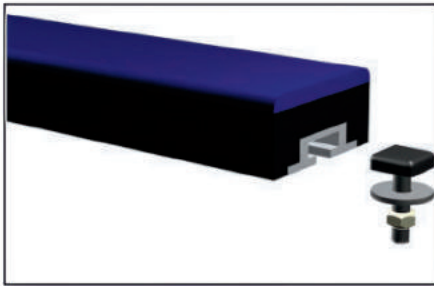

Construction Type T

TYPE 'T'

This pad having 'T' type reinforcement and clamping is done with square headed 'T' bolts, nylock nuts & washers.

Benefits	Features
Regular maintenance and lubrication not required	No revolving parts
No under cutting & damage of belt	More belt contact area
Reduces spillage at loading zone	Continuous support under the belt
Long service life	High wear resistant UHMWPE top layer
Improved Impact energy absorption	Fastening - independent pad construction

Support Frame:

Support frames are designed to suit a wide range of applications for impact pad.

Support Frames for impact pads can be provided as per **customer** requirements and specifications.

Support frames are mainly categorized into 3 types:

1. Light Duty Frame
2. Medium Duty Frame
3. Heavy Duty Frame

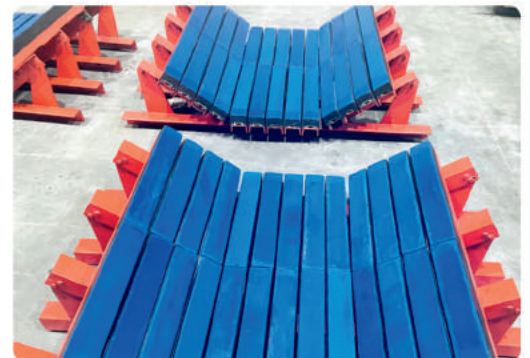

Rows of Pad Required for Each Loading Solution

Belt Width (mm)	600 / 650	750 / 800	1000	1200	1400	1600	1800	2000	2200	2400
No. of rows	6	7	9	10	12	14	15	17	19	20



POLYURETHANE PRODUCTS

Polyurethane (PU) combines the best properties of both plastic and rubber. It offers abrasion and tear resistance, high tensile and elongation values and low compression set. Polyurethane is naturally flexible and exhibits virtually unlimited flexural abilities.

Combining good chemical resistance and excellent weathering characteristics sets polyurethane apart from most other thermoplastics. It has exceptional resistance to most gasolines, oils, kerosene and other petroleum based chemicals.

ATLAS RUBBERS provide polyurethane manufacturing solutions for high and low volume production. Manufactured using high-performance resins, curatives and additives, our polyurethane products can be manufactured in almost any hardness or shape. This is possible through a number of manufacturing processes which employ state-of-the-art technology at each processing step. With experience in highly customized products, we welcome complicated projects and difficult applications.

Types of PU Products



POLYURETHANE

Majorly used and manufactured Polyurethane Products are:

- PU SEALS
- PU LINER
- PU SHEETS
- PU CORDS & TUBES
- PU SKIRTS & COUPLINGS
- PU SCRAPPER
- PU RINGS
- PU BUSHES



PU BUSH



PU SEALS



PU TUBES



PU SCRAPPER



PU RINGS



PU COUPLINGS



PU LINERS

- Apart from the above listed products, we also manufacture PU Products based on customer specifications and requirements

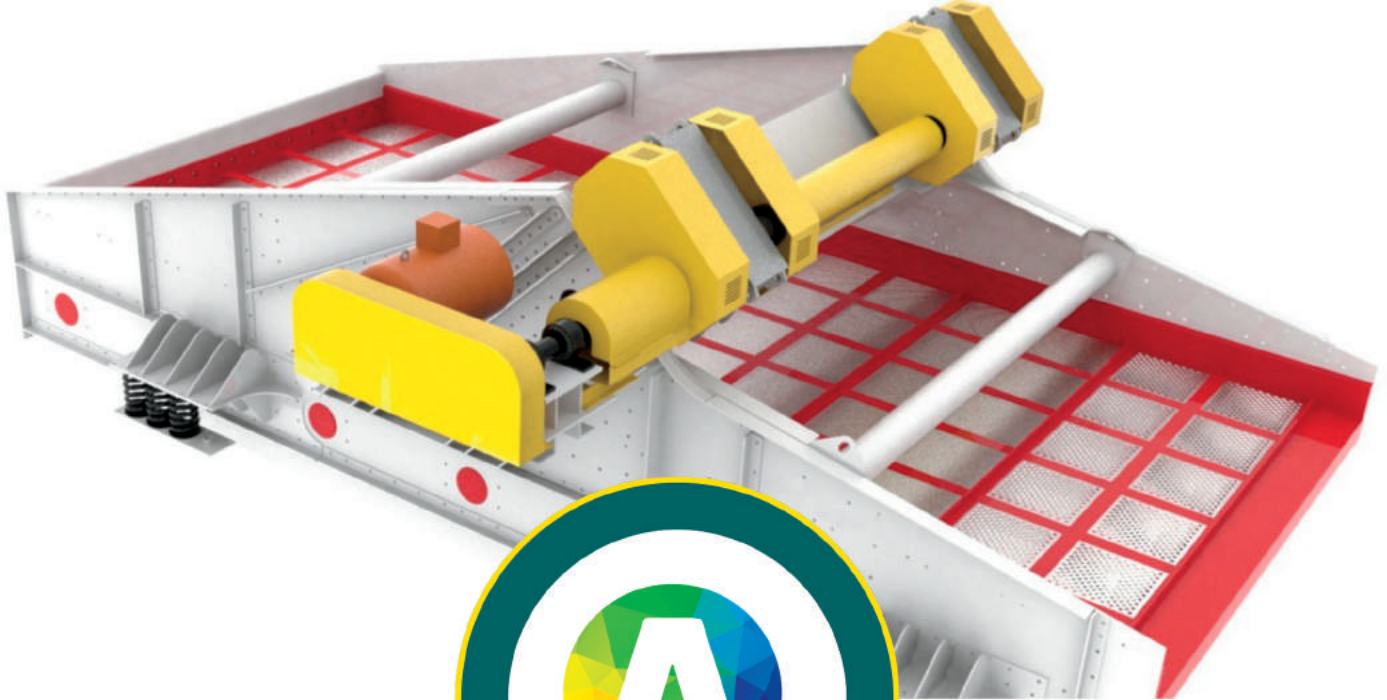

VIBRATING SCREENS

Conventionally, woven wire mesh or punched steel plated were used as screening media in the plants handling cement, aggregate and other material in the mining and mineral processing industry. However, since wire mesh screens required frequent replacement, the cost of resultant downtime was a primary concern for the management. Offering an ideal solution to these problems is ATLAS specialized rubber and polyurethane vibrating screens.

Equipped with high operating efficiency, long life and minimum maintenance requirements, ATLAS Vibrating Screens provide a substantial saving for every ton of material screened. In actual field, rubber and polyurethane screens have gained world wide acceptance and have proven to be far more effective than conventional media.

Advantages of ATLAS Vibrating Screens

Long Life Deck	Lower Cost per Tonn Higher Productivity
Easy to fit	Substantial saving on downtime loss
High open area and flaring hole design	Gives more throughput
Reduction in noise level	Improves working environment Accurate Productivity



Variety of Vibrating Screens

VIBRATING SCREENS

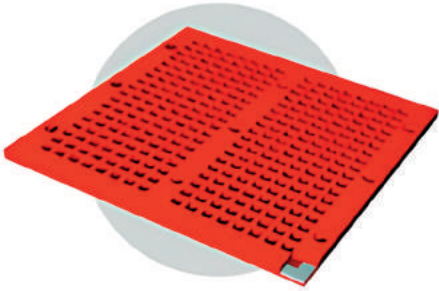

Bolt Down Panel

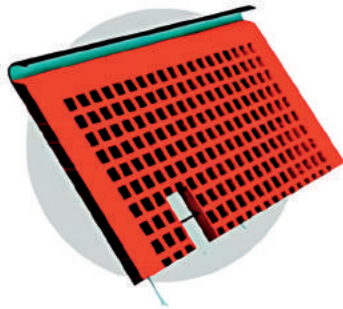

Cross Tension Panel



Flip Flo Panel

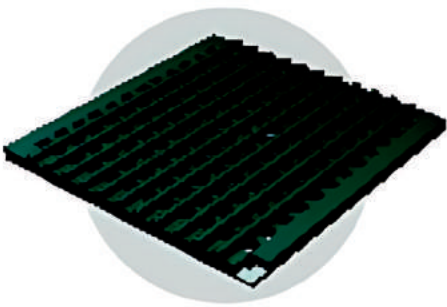

Panel Cord



Dewatering Panel

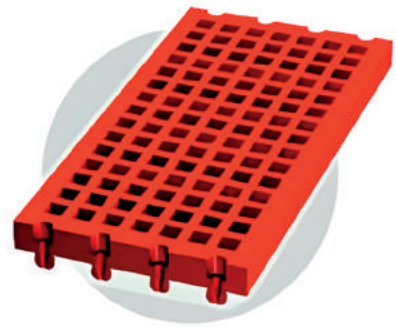

Polysnap Panel

Applications

Scalping, Primary, Secondary, Tertiary & Final Screening

Primary, Medium & Heavy Duty Screens

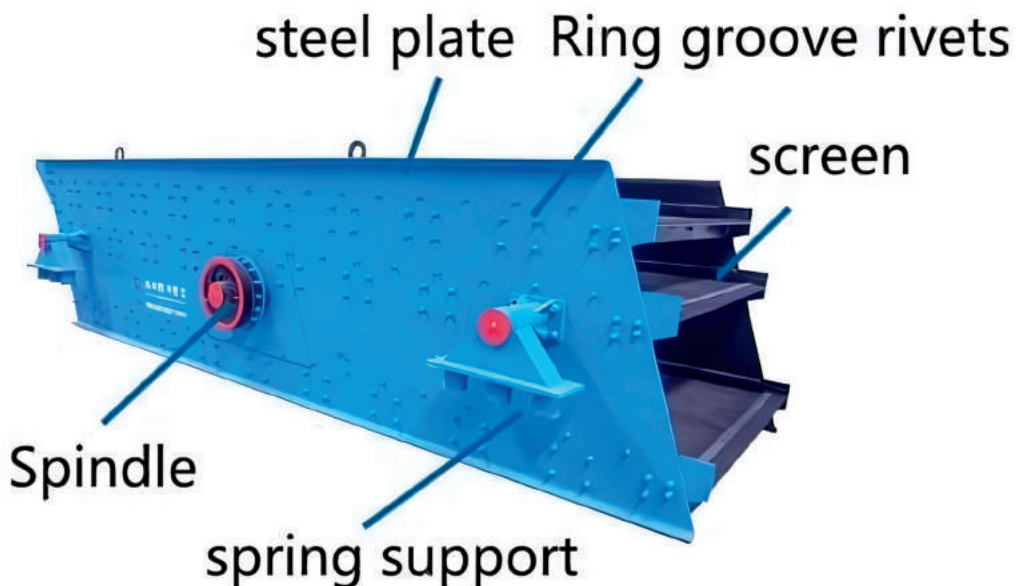



AIR BLASTERS

The Air Blaster provides an excellent solution when it comes to breaking the adhesive and cohesive forces of materials stored in the material handling equipments, thereby restoring free flow of materials.

By firing the air blasters in an adjustable sequence by means of an electronic control box, blockages can be avoided and the full capacity of the equipment is utilized. As the quantity of air is very small in proportion to the volume of the storage equipment, the energy of the blast is dissipated and absorbed by the material. There is no damage whatsoever to the structure.

By eliminating obstructions and buildups that restrict flow, your operation can process more material faster, resulting in multiple positive outcomes, such as:

- **Improved efficiency** - Eliminating obstructions and buildup substantially improves throughput without adding significant labor or energy costs.
- **Safer work conditions** - Workers no longer have to climb inside containers or under unloading ports to break up blockages manually.
- **Less wear and tear on equipment** - Cleaning and unblocking bulk materials manually require tools that damage equipment over time, while air cannons use harmless bursts of air.
- **Reduced downtime** - Because the air cannon fires at timed intervals, the material doesn't have a chance to build up in the first place, so there's no need to shut down to remove obstructions.



Our Other Products

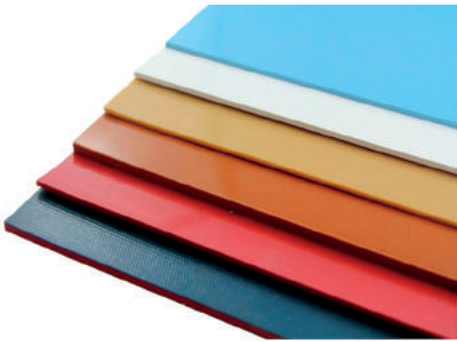

RUBBER SHEETS

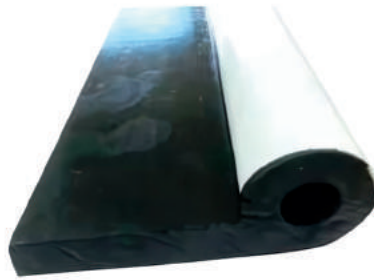

GATE SEALS



CHEVRON SEAL



O RINGS



OIL SEALS



DIAPHRAGMS



RUBBER GASKETS



RUBBER BUSH



RUBBER PROFILES



RUBBER CORD



INSULATING MAT



EXPANSION BELLOWS

OUR ESTEEMED CLIENTS



ACC



NALCO Water
An Ecolab Company

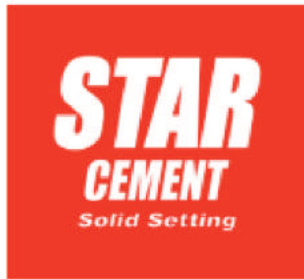



ATLAS RUBBERS & ENGINEERS

Registered Office & Works: Talepukur Dhar, Makardah, Howrah Amta Road,
Howrah - 711409, West Bengal, India Email: atlasrubberkol@gmail.com
Mob : 99035 02104 | 97485 43573 Website: www.atlasrubbers.com

Manufacturers of : Conveyor Skirt System, Rubber Liners, Rubber Sheets,
Rubber Lining, Vessel Lagging, Ceramic Lagging, Ceramic Liner, Polymer Liner,
Polyurethane Products, Air Blaster & All kinds of Polymer Moulded Products